



# Acme Sanitary Ware Co Ltd







Acme Building, 22-28 Nanking Street, Kowloon, Hong Kong  
 Tel: 2388 7171 Fax: 2710 8012  
 E-mail: acme@acmesanitary.com.hk  
 Website: www.acmesanitaryware.com.hk



Pure Freude  
an Wasser

PROJECT		REF		REV	ITEM CODE	
LOCATION		DATE			PAGE	

## SANITARY WARE SPECIFICATION SHEET

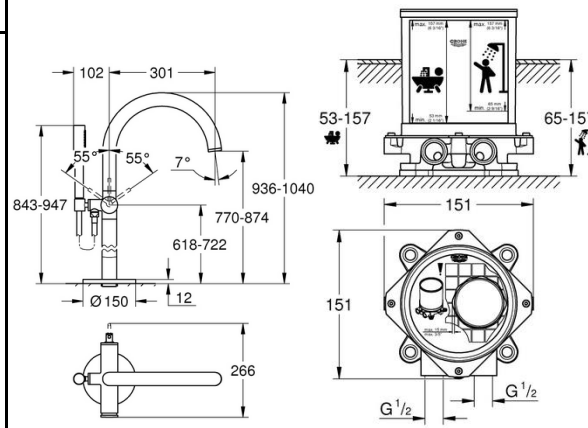
Item Descriptions	GROHE (Germany) "Atrio" Floor mounted single-lever free stand bath & shower mixer with single functions hand spray; nominated flow rate <b>6.3 L/min</b> in WELS <b>Grade 1</b> ; Registration No. <b>SB 18-0030</b>	Illustration/ Drawing													
Dimensions	L301 x W266 x H1040 mm	 <div></div>													
Model	32653003 (Mixer) 45984001 (Mounting box)														
Finish / Material	Chrome Plated														
Country of origin	Germany														
Manufacturer	GROHE Limited														
Supplier	Acme Sanitary Ware Co. Ltd Mr. Eric Wong/ Mr. Don Yuen	<table><tr><td>Dynamic flow pressure (kPa)</td><td>50</td><td>150</td><td>250</td><td>350</td><td>500</td></tr><tr><td>Flow rate (l/ min)</td><td>4.35</td><td>6.35</td><td>6.23</td><td>6.45</td><td>6.80</td></tr></table>		Dynamic flow pressure (kPa)	50	150	250	350	500	Flow rate (l/ min)	4.35	6.35	6.23	6.45	6.80
Dynamic flow pressure (kPa)	50	150	250	350	500										
Flow rate (l/ min)	4.35	6.35	6.23	6.45	6.80										
Contact Tel/Fax	(852) 2388-7171 / (852) 2710-8012														
E-mail	acme@acmesanitary.com.hk														
Website	www.acmesanitary.com.hk														
<b>Single-lever bath mixer</b> <ul style="list-style-type: none"><li>set for final installation for</li><li><b>without roughing-in-set</b></li><li><b>GROHE SilkMove</b> 35 mm ceramic cartridge</li><li>with temperature limiter</li><li><b>GROHE StarLight</b> chrome finish</li><li>automatic diverter: bath/shower</li><li>spout with mousseur</li><li>projection 301 mm</li><li>integrated non-return valve in the shower outlet 1/2"</li><li>with shower holder</li><li>hand shower Sena Stick (26 465)</li><li>Silverflex shower hose 1250 mm</li><li>protected against backflow</li></ul> 		<b>Rough-in set 1/2"</b> <ul style="list-style-type: none"><li>for floor-mounted bath mixers/spouts and shower mixers</li><li><b>without finishing trim set</b></li><li>installation plate with 360° horizontal and 3° vertical adjustment</li><li>installation depth 53-157 mm for bath mixers/spouts, depth compensation 104 mm</li><li>installation depth 65-157 mm for shower mixers, depth compensation 92 mm</li><li>two 1/2" female connections (hot/cold supplies)</li><li>flushing plug</li><li>Can take a single mixed supply</li><li>fixing material</li></ul> 													
															
		<b>Colour options:</b> <table><tr><td>003   StarLight Chrome</td><td>GL3   Cool Sunrise</td></tr><tr><td>DC3   SuperSteel</td><td>GN3   Brushed Cool Sunrise</td></tr><tr><td>DA3   Warm Sunset</td><td>DL3   Brushed Warm Sunset</td></tr><tr><td>A03   Hard Graphite</td><td>BE3   Polished Nickel</td></tr><tr><td>AL3   Brushed Hard Graphite</td><td>EN3   Brushed Nickel</td></tr></table>		003   StarLight Chrome	GL3   Cool Sunrise	DC3   SuperSteel	GN3   Brushed Cool Sunrise	DA3   Warm Sunset	DL3   Brushed Warm Sunset	A03   Hard Graphite	BE3   Polished Nickel	AL3   Brushed Hard Graphite	EN3   Brushed Nickel		
003   StarLight Chrome	GL3   Cool Sunrise														
DC3   SuperSteel	GN3   Brushed Cool Sunrise														
DA3   Warm Sunset	DL3   Brushed Warm Sunset														
A03   Hard Graphite	BE3   Polished Nickel														
AL3   Brushed Hard Graphite	EN3   Brushed Nickel														

Note: [YouTube \(GROHE Atrio Product\) https://www.youtube.com/watch?v=HJDtY\\_EFMdM](https://www.youtube.com/watch?v=HJDtY_EFMdM)

[YouTube \(Mounting box\) https://www.youtube.com/watch?v=6dTaw9z96So](https://www.youtube.com/watch?v=6dTaw9z96So)

\* All information of the above is for the reference only. No prior notice is made if any changes.



## Acme Sanitary Ware Co Ltd

Acme Building, 22-28 Nanking Street, Kowloon, Hong Kong  
Tel: 2388 7171 Fax: 2710 8012  
E-mail: acme@acmesanitary.com.hk  
Website: www.acmesanitaryware.com.hk



Pure Freude  
an Wasser

PROJECT		REF		REV	ITEM CODE	
LOCATION		DATE			PAGE	

## SANITARY WARE SPECIFICATION SHEET

### GROHE ATRIO

#### THE ICON OF ELEGANCE AND PRECISION

Consider the circle. A staple of natural geometry. A pure form at once soothing and dynamic. A visual metaphor for both, completeness and eternity. For its Atrio collection GROHE draws on this most elemental and elegant form to create an iconic object that is built to last.

The Atrio collection means design without restrictions. Each item is available in various finishes and size options to meet all demands of personal taste and different design schemes.

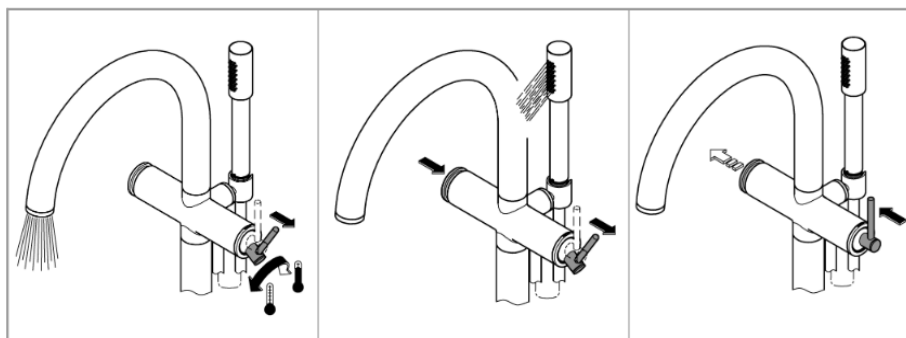
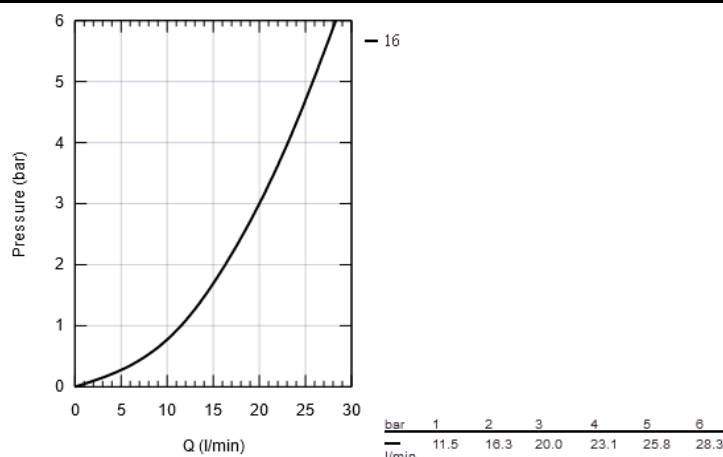

#### SPARE PARTS

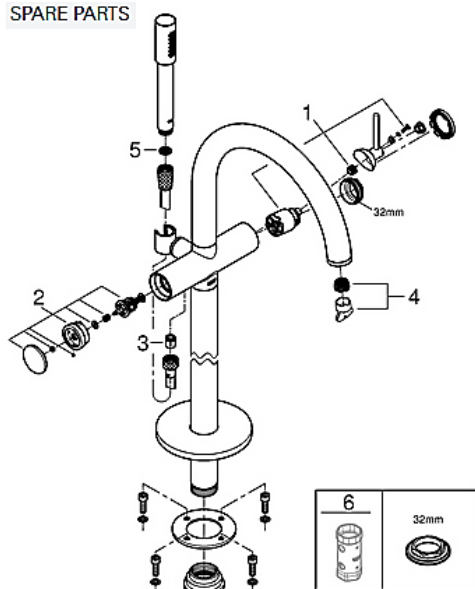

Pos.-nr.	Prod. description	Order-nr.
1	Cartridge	46374000
2	Diverter	48405000
3	Non-return valve	08565000
4	Mousseur	13926000
5	Dirt strainer	0700200M
6	Socket spanner	19332000*



CERTIFICATION MARK

Note:

\* All information of the above is for the reference only. No prior notice is made if any changes.

註冊號碼 (Registration No.): SB 18-0030



自願參與用水效益標籤計劃 - 沐浴花灑  
Voluntary Water Efficiency Labelling Scheme - Showers for Bathing



This is to certify that

將下列花灑在本計劃內註冊：  
has registered the following shower under this scheme :

牌 子 / Brand	:	GROHE
型 號 / Model	:	26465XXX
原產地 / Country or Region Origin	:	Germany

在用水效益標籤上展示的標誌 <i>Symbolic Presentation on the Water Efficiency Label</i>	:	 滴水點 <i>Water droplet(s)</i>
用水效益級別 <i>Water Efficiency Grade</i>	:	1
耗水量 <i>Water Consumption</i>	:	6.3 公升/分鐘 <i>litres/minute</i>

簽發日期:  
Date of Issue: 14 February 2018



水務署  
Water Supplies Department



水務署署長(周世威代行)  
for Director of Water Supplies



水務署  
Water Supply Department



總部 Headquarters  
香港灣仔告士打道117號  
48/F, Immigration Building, 117 Gt. Victoria Road, Wan Chai, Hong Kong

本署檔號 : (2) in WSD 3321/19 Pt.1 T/J(180)  
Our ref.  
來函檔號 :  
Your ref.

電話 :  
Tel.  
傳真 : 2824 0578  
Fax.

13 March 2019

### Approval of "GROHE" Bath/Shower Mixer (General Acceptance No. C20190179)

Your letter ref. WRC/2036 dated 13 February 2019 refers.

Having considered the test report ref. J23606 issued on 15 January 2019 by Nutek Systems (HK) Ltd., this Authority accepts that the fitting described below complies with, and its use when correctly installed does not contravene, the Waterworks Ordinance and Regulations.

**Name of Manufacturer:** Grohe AG  
**Country of Origin:** Germany  
**Brand:** Grohe  
**Details of Fitting:** 1/2" Floor mounted single lever bath/shower mixer  
**Model:** 45984001 + 32653XX3  
(where the digits "XX" denote the code of colour)  
**Body Markings:**   
**Expiry Date:** 26 November 2023





This Authority hereby permits the use of the above fitting in fresh water plumbing systems subject to full adherence to Waterworks installation requirements. In particular, you are required to draw your customers' attention to the following requirement-

"The cold water supply to the fitting shall be drawn from the same source that supplies the hot water apparatus so as to provide a balanced pressure and to obviate the risk of scalding in the event of a restriction or failure in the water supply." AND

"The shower head or handspray should not be placed in submerged conditions and should be securely fixed to the original position after use."

A condition of this acceptance is that the fitting to be installed shall be replicas of the sample as certified by the testing agent mentioned above and without modifications. This acceptance may be withdrawn at any time if the standard of the fitting installed fails to meet that of the approved sample or if the fitting is found to be unsuitable for use in fresh water plumbing systems.

This acceptance is only applicable to the main body of the fitting, unless other specified.

For the use of the fitting in any project, the General Acceptance Number of this letter must be quoted as a means of identification of acceptance of the fitting by this Authority.

Should you have any enquiries, please contact our Engineer Mr. Terry KUNG at tel. no. 3583 4086.

Yours faithfully,



(CHAN Chung-kun)

for Director of Water Supplies

Encl.

c.c.      WSD 3321/1/82    ] - without catalogue  
             ME/MC            ] - with soft copy only